



## Fitly Joined Together (A Practical Lesson)

*James 1:23-24*

*For if any be a hearer of the word, and not a doer, he is like unto a man beholding his natural face in a glass: For he beholdeth himself, and goeth his way, and straightway forgetteth what manner of man he was.*

After each church camp, we are always very recharged and full of zeal to apply what we learnt during the camp. This year, in addition to that goal, I was made aware that such zeal abates very fast and wondered if I would soon be like what James said – looking at my image in the mirror and walking away forgetting what I saw? God saw it fit to show me a practical lesson that would further impressed upon me the lessons learnt during the camp.

On 19<sup>th</sup> June, just three days after the church camp ended, Beulah House was closed due to safety reasons. That triggered the Relocation Plan pre-maturely. The foremost biggest challenge was how to house everyone during Sunday School (SS) time in the main compound.

Over the next few weeks, plans were executed to house the Young Teens & Senior Departments, who were previously using Beulah House, for Sunday School. Each SS departmental level sacrificed one way or another either by giving up rooms, merging classes together or even giving up more comfortable room (air con) for hotter ones. That's great sacrifice during these hottest months of the year!

This is a very encouraging sight. These two teen departments are our next generation of leaders in fifteen years time. Many of them are still needful of spiritual milk. They should be grounded well in God's Word so that when the time comes, they are better able to receive the baton from the leaders. What better gift now than to give them a good environment to learn God's Word.

Our teens today are very much attacked by the media and the vile tricks of the devil. One of which is humanism – to want to be in control, and not submitting to authority. They need the right guidance and the right example to be set before them by the elder brethren who are feeding on strong meat.

I am very thankful that the leaders and the many adults who have set the example of how to sacrifice to the good of the body of Christ.

*1 Corinthians 12:25-27*

*That there should be no schism in the body; but that the members should have the same care one for another. And whether one member suffer, all the members suffer with it; or one member be honored, all the members rejoice with it. Now ye are the body of Christ, and members in particular.*

If my leg hurts, would not the whole body be affected? Would not I try to use my hands to lessen pain etc? Similarly, the teens are the affected part of the body of Christ seeking a place to learn God's Word. The rest of us are the other parts of the body rallying to help so that the whole body of Christ may function well again. We must always endeavour to keep the body of Christ united.

Thank God for this lesson and a testing to His people for the spiritual food ingested during the camp. - JK

## Relocation Update

- **Please check the updated class location on Back Page.**
- **All SS students in Adult Class 1 are to proceed into the Main Sanctuary GROUND FLOOR to attend the class.**
- **GENTLE REMINDER : All who are outside the FEK rooms are advised to create a more conducive environment for the SS class to study God's Word at the Red Porch.**

# Relocation Update

| DEPARTMENT   | LOCATION  | DEPARTMENT  | LOCATION  |
|--|---|---|---|
| <b>PRIMARY</b><br>All classes (except Pre-N) gathers at Greek & Hebrew Classroom 2 for singspiration first<br>Pre Nursery<br>Nursery + K1<br>K2<br>P1 + P2 | FEK 1<br>FEK 3<br>FEK 4<br>Greek & Hebrew Classroom 2   | <b>YOUNG TEENS</b><br>Sec 1 Boys<br>Sec 1 Girls (A)<br>Sec 1 Girls (B)<br>Sec 2 Boys<br>Sec 2 Girls<br>Sec 3 Mixed<br>Sec 4 Boys<br>Sec 4 Girls | Jerusalem Court<br>Reference Library<br>MF Room<br>Cry Room (Main Hall)<br>MIS Office<br>Greek+Hebrew Classroom 1<br>Korean Office<br>Internet Room |
| <b>JUNIOR</b><br>P3 Mixed<br>P4 & P5 Boys<br>P4 & P5 Girls<br>P6 Mixed   | 2nd Parsonage Hall<br>2nd Parsonage Library 1<br>2nd Parsonage Library 2<br>FEBC Library              | <b>SENIORS</b><br>1B<br>1G<br>2B<br>2G1<br>2G2<br>NS 2<br>3B/NS 1<br>3G   | FEK Kitchen<br>Tape Library<br>Bell Tower<br>Church Office<br>Ladies Dorm Kitchen<br>FEBC Dormitory Corridor<br>Cry Room Kitchen<br>FEK Classroom 2 |
| <b>ADULTS</b><br>Class 1<br>Class 2<br>Class 3<br>Class 4<br>Class 5<br>Class 6  | Main Sanctuary<br>Sharon Church Office<br>Balcony<br>Piano Room<br>Red Porch<br>2nd Parsonage Kitchen |   |   |

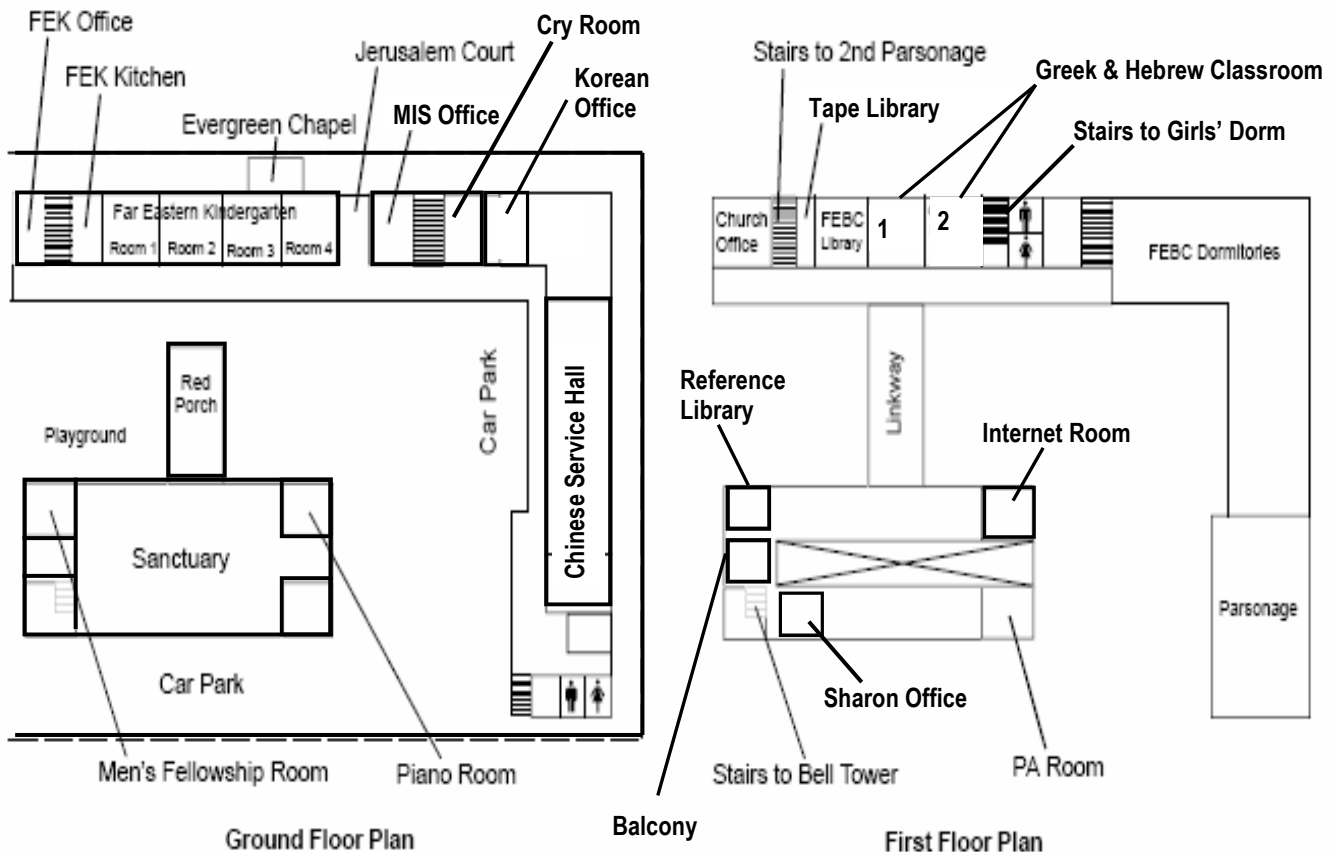

## SANCTUARY AND L-BLOCK (9A GILSTEAD ROAD)